



**RCSI**  
**SIM**



**RCSI CENTRE FOR  
SIMULATION EDUCATION  
AND RESEARCH**





26 York Street is Europe's largest and most modern healthcare facility, providing an emotionally rich and rewarding educational experience for students. Located in the heart of Dublin with a student community of over 60 nationalities, we have a global perspective on how we train tomorrow's clinical professionals, today. Benchmarked against best in class, 26 York Street is a world-class facility for training the next generation of healthcare leaders.



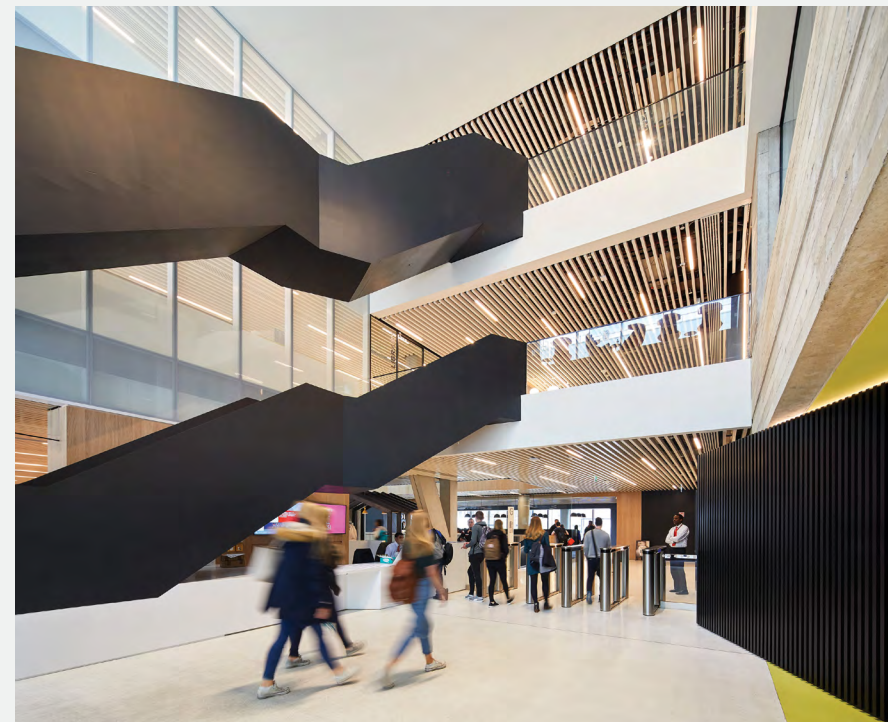

RCSI's world-leading centre for professional education, research and innovation in healthcare occupies ten floors and comprises:

- ~ Surgical training labs
- ~ Training rooms
- ~ Tutorial rooms
- ~ Clinical simulation facilities
- ~ 600 student capacity library
- ~ 540 seat lecture theatre
- ~ Student sports hall
- ~ Café
- ~ Gymnasium





Designed to provide hands-on practical, professional healthcare training in multiple learning and study environments.

#### LIBRARY

# 600

The library spans three floors and has the capacity for 600 students. It includes silent study zones, an amphitheatre, postgraduate suite, collaborative zones, computer rooms and reading lounge.

#### AUDITORIUM

# 540

The building features a 540 seat state-of-the-art lecture theatre which is surrounded by tutorial rooms, computer and language labs.



This state-of-the-art world-class facility provides a national capacity for surgeons to refresh their skills and to learn about innovative techniques and international advancements. 26 York Street is a world-class clinical learning environment, enabling a truly transformative clinical learning experience.

## CLINICAL SKILLS LABS

2

Students have the opportunity to learn safe surgical practice and develop operative skills in a state-of-the-art surgical training suite with a mock operating theatre and clinical training wards.

## HOSPITAL ROOMS

4

**1 MOCK WARD**  
**1 MOCK OPERATION ROOM**  
**1 MOCK RESUSCITATION ROOM**

Students can improve their technical and non-technical clinical skills, working both as individuals and in teams.

## CLINICAL OUTPATIENT ROOMS

10

Students can develop core technical and non-technical skills in a safe, simulated environment, allowing early clinical education to be delivered away from the patient's bedside.





- Simulation Space
- Teaching Space
- Technical Support Space
- Storage Space
- Simulated Patient Space

*Please click on a room to see more details*

## 3<sup>rd</sup> FLOOR PLAN

The third floor includes 10 flexible consultation rooms, adjoined by a central control corridor and supported by a Patient Lounge. It also boasts a 50-seater flexible lecture/practical space, tutorial rooms, changing rooms and catering space.



**3<sup>rd</sup> FLOOR****Mutchnik Theatre (306)**

302 is a flexible teaching space, which can be set for up to 50 people seated classroom style. The space can also be configured with patient couches for physical exam or ultrasound practice, or with tables for practical skills. Four large scrub sinks at the back of the room also accommodate scrubbing and hand hygiene practice.

**Capacity:** 50

**AV:** Yes

**Video Conference:** Yes

**Learning Space Cameras:** Yes

**Room usage:** Procedural Skills, Scenario Based Simulation, Didactic teaching, Conference, Workshops and Exams/OSCEs.



**3<sup>rd</sup> FLOOR****Out-Patient Rooms (304 – 313)**

Simulation space on the third floor is built around a central control corridor and includes 10 consultation rooms which can represent flexibly represent a variety of outpatient settings. These spaces are perfect for OSCE-style examinations and consultation skills sessions.

**Capacity:** 8

**AV:** No

**Video Conference:** No

**Learning Space Cameras:** Yes

**Room usage:** Scenario Based Simulation, Communications Skills, and OSCEs.





**3<sup>rd</sup> FLOOR****Patient Lounge (314)**

The Patient Lounge is a dedicated space for Simulated Patients, surface models and actors to congregate. During examinations, this can also be used as a briefing or meeting space. It includes a small kitchen space with tea and coffee facilities, a meeting table and study spaces.

**Capacity:** 15

**AV:** Yes

**Video Conference:** No

**Learning Space Cameras:** No

**Room usage:** Simulated Patients.  
If available, it could be used for meetings.





**3<sup>rd</sup> FLOOR****Double Tutorial Rooms**

(322/323, 324/325)

**Capacity:** 30**AV:** Yes**Video Conference:** Yes**Learning Space Cameras:** No

**Room usage:** Procedural Skills, Scenario Based Simulation, Didactic teaching, Conference, Workshops and Exams/OSCEs.





**3<sup>rd</sup> FLOOR**

## Single Tutorial Rooms (321, 326)

Capacity: 18

AV: Yes

Video Conference: Yes

Learning Space Cameras: No

Room usage: Procedural Skills,  
Scenario Based Simulation, Didactic  
teaching, Conference, Workshops  
and Exams/OSCEs.





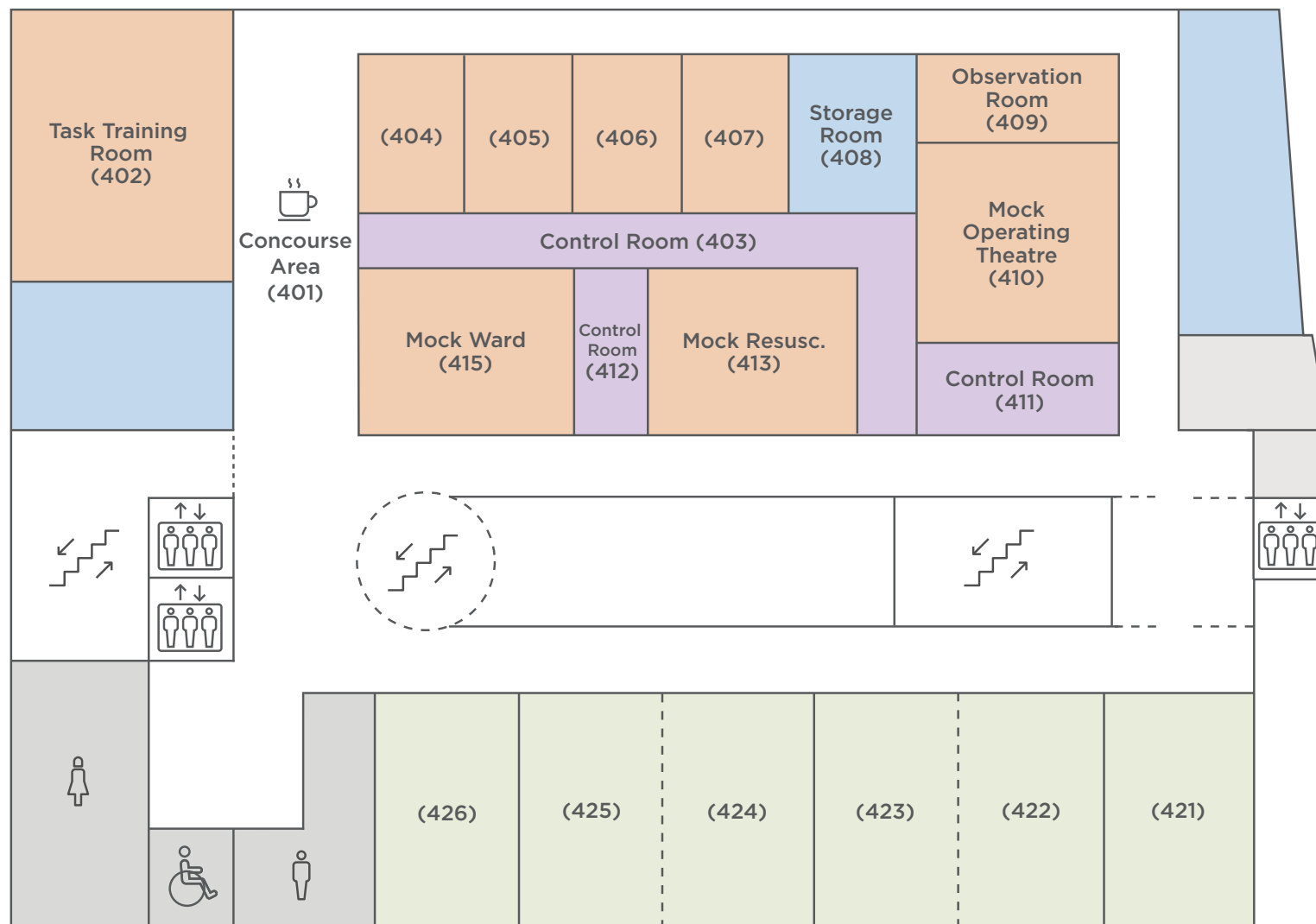

*Please click on a room to see more details*

## 4<sup>th</sup> FLOOR PLAN

The fourth floor is our “simulated hospital” space.

It includes:

- 4 single inpatient rooms suitable for use with actors/Simulated Patients
- A Mock Ward and Mock Resusc. with adjoining control room
- A flexible OR/ED space with large control room and direct observation room
- A dedicated Task Training space for undergraduate clinical skills.

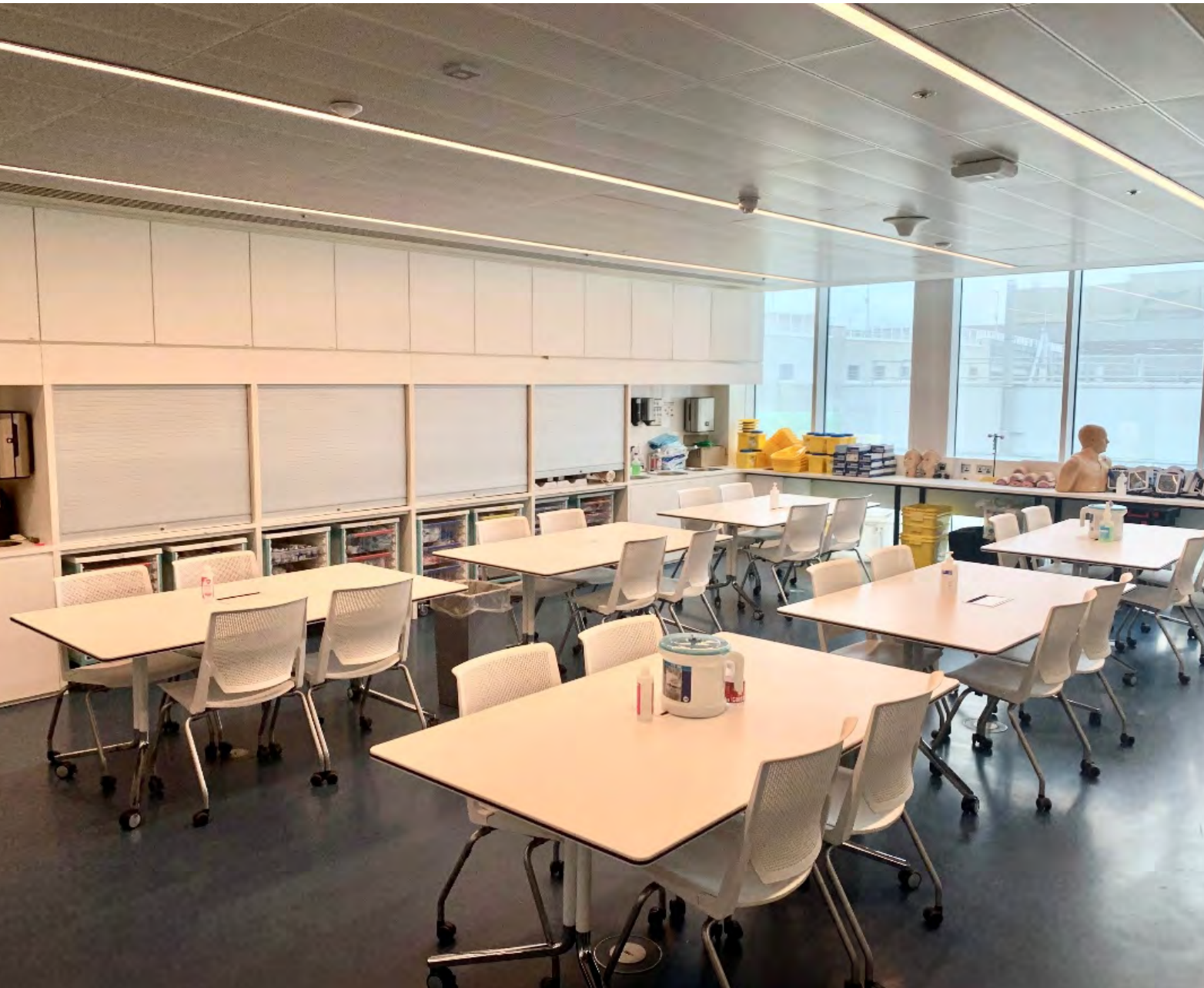
**4<sup>th</sup> FLOOR****Task Training Room (402)**

The Task Training Room allows learners to practice their clinical skills in a safe environment using synthetic task trainers. There is no AV equipment in this space, maintaining the focus on deliberate practice.

**Capacity: 24**

**AV: No**

**Video Conference: No**

**Learning Space Cameras: No**

**Room usage: Procedural Skills & OSCEs.**

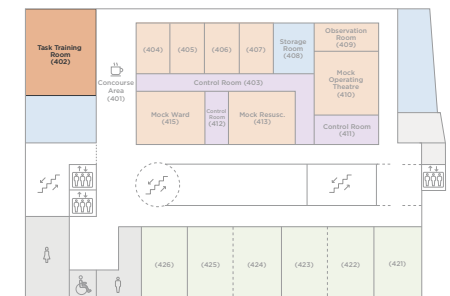



**4<sup>th</sup> FLOOR****In-Patient Rooms (404-408)**

Four single inpatient rooms are equipped for communication skills, scenario based teaching and simulated ward rounds. Each single inpatient room is equipped with a bed, wall-mounted monitor, simulated medical gasses, telephone port and sink. Additional equipment such as vital signs monitors is available upon request.

**Capacity: 8**

**AV: No**

**Video Conference: No**

**Learning Space Cameras: Yes**

**Room usage: Communication Skills, Scenario Based Simulation, OSCEs.**

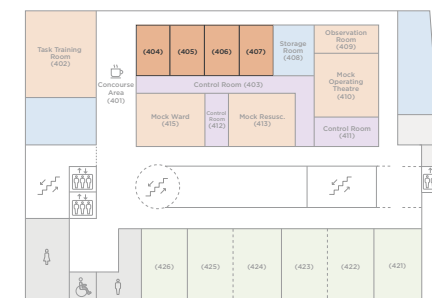

**4<sup>th</sup> FLOOR****Mock OR  
(409, 410)**

This flexible space can be set up as an OR or ED setting. It includes simulated medical gases, operating lights, crash cart with defibrillator and patient trolley with SimMan Trauma. Additional equipment such as an anaesthetic machine, OR table etc. is available on request. The adjoining large control room allows faculty to run the manikin and field calls for assistance, while the Observation Room affords colleagues a direct view of the action.

**Capacity:** 8

**AV:** No

**Video Conference:** No

**Learning Space Cameras:** Yes

**Room usage:** Scenario Based  
Simulation & OSCEs.





**4<sup>th</sup> FLOOR****Mock Resus (413)**

The Mock Resusc room is a large flexible space which can accommodate up to two patient beds. As standard, it is configured with SimMan 3G, wall-mounted monitors, simulated medical gasses, and a crash cart. The adjoining control room allows faculty to run the manikin and field calls. Scenarios can also be viewed from a tutorial room using Learning Space.

**Capacity:** 16

**AV:** No

**Video Conference:** No

**Learning Space Cameras:** Yes

**Room usage:** Scenario Based Simulation & OSCEs

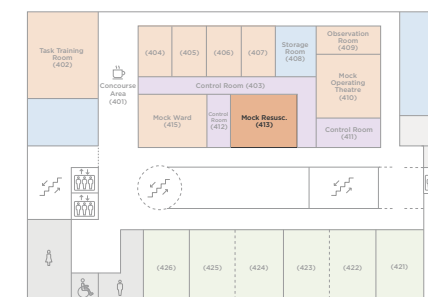

**4<sup>th</sup> FLOOR****Mock Ward (415)**

The Mock Ward is most commonly configured as a two-bed Labour Ward with two CAE Lucina manikins. It includes wall-mounted monitors, simulated medical gasses and an adjoining control room.

**Capacity:** 16

**AV:** No

**Video Conference:** No

**Learning Space Cameras:** Yes

**Room usage:** Scenario Based Simulation & OSCEs





**4<sup>th</sup> FLOOR****Double Tutorial Rooms**

(422/423, 424/425)

**Capacity:** 30**AV:** Yes**Video Conference:** Yes**Learning Space Cameras:** No

**Room usage:** Procedural Skills, Scenario Based Simulation, Didactic teaching, Conference, Workshops and Exams/OSCEs.



**4<sup>th</sup> FLOOR****Single Tutorial Rooms**

(321, 326)

**Capacity: 18****AV: Yes****Video Conference: Yes****Learning Space Cameras: No**

**Room usage:** Procedural Skills,  
Scenario Based Simulation, Didactic  
teaching, Conference, Workshops  
and Exams/OSCEs.

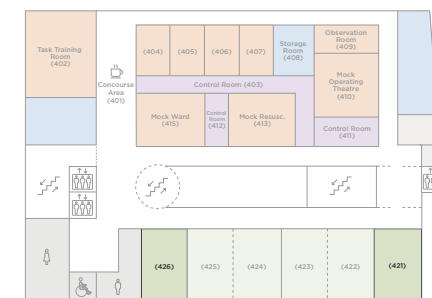



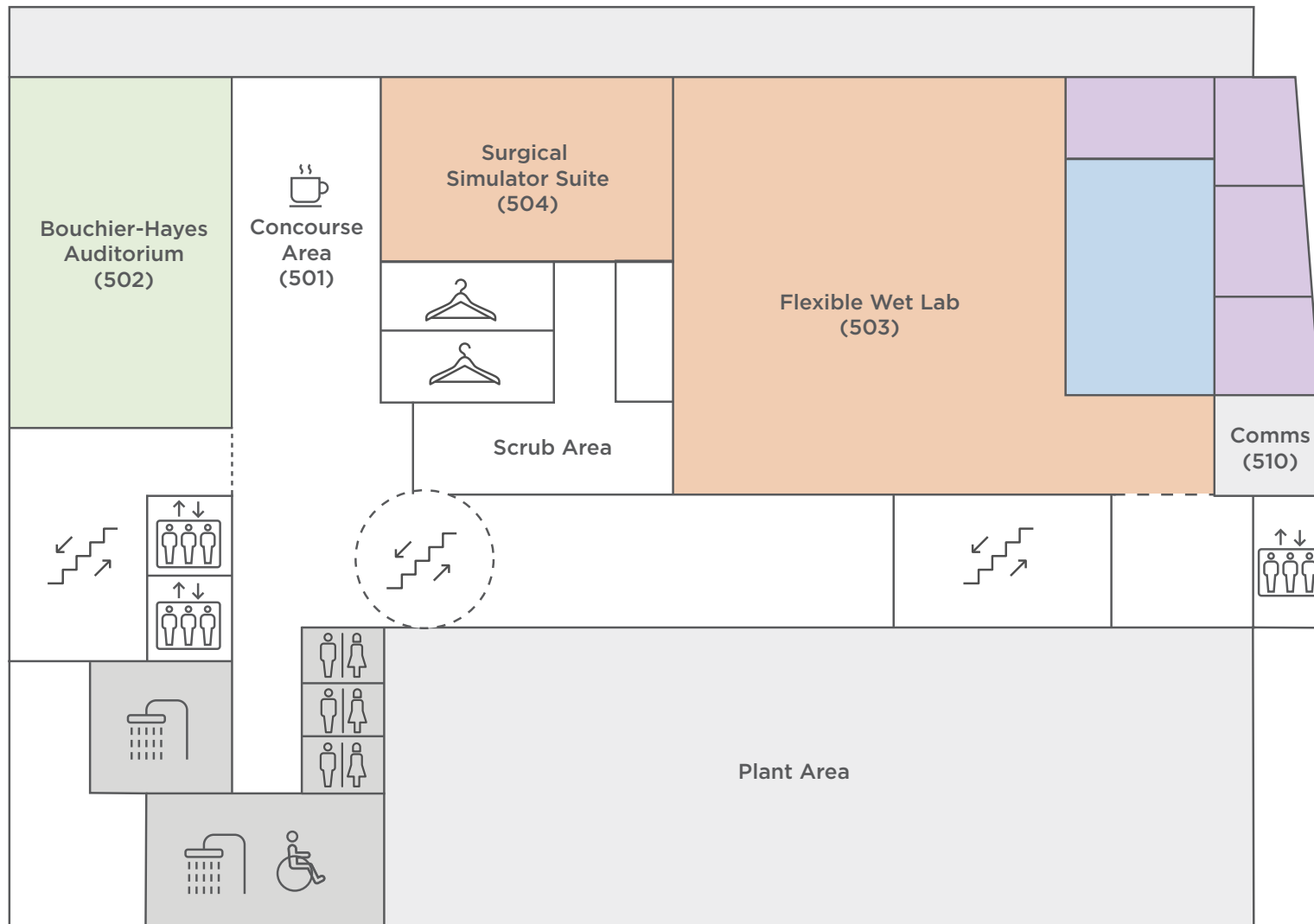

- Simulation Space
- Teaching Space
- Technical Support Space
- Storage Space
- Simulated Patient Space

*Please click on a room to see more details*

## 5<sup>th</sup> FLOOR PLAN

The fifth floor is dedicated to surgical training spaces. This includes a large flexible Wet Lab and adjoining Surgical Simulator Suite. These are supported by changing spaces and a scrub area.

The 50-seater Bouchier-Hayes Auditorium is a comfortable setting for didactic teaching and video conferencing, while a catering station provides break-out space.



The Wet Lab is a bright 900m2 designed for surgical skills teaching. The space is most commonly configured with 9 stations, each seating 2-3 learners. Each station includes operating lights, adjustable surgical table, Learning Space camera and power points. Three demonstration stations at the back of the lab are equipped with 4k cameras and monitors. Laparoscopic stacks, box trainers, energy devices, suction etc. can be set up on request. This lab can facilitate surgical skills practice through the use of biological specimens and hybrid simulators.

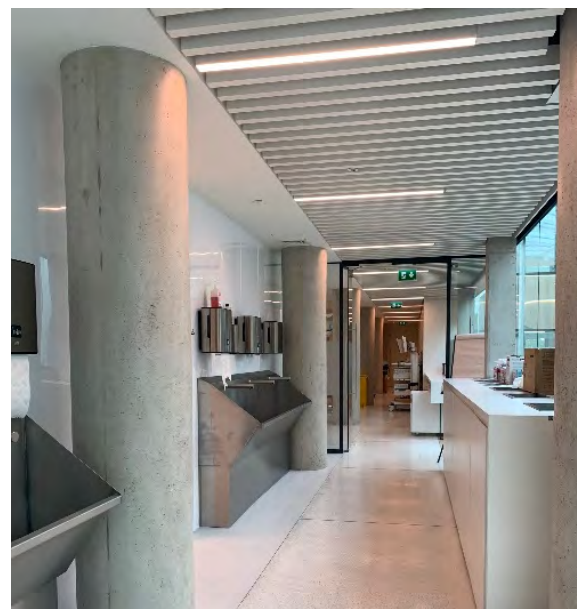

## 5<sup>th</sup> FLOOR

# Wet Lab & Scrubs Area (503)

Capacity: 24

AV: Yes

Video Conference: Yes

Learning Space Cameras: No

Room usage: Surgical Skills.

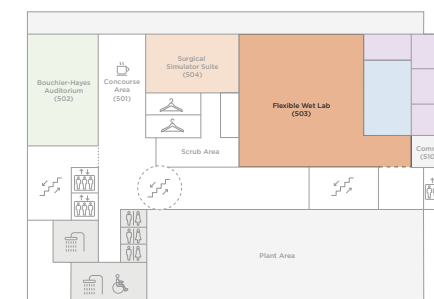



**5<sup>th</sup> FLOOR**

## Surgical Simulator Suite (504)

The Surgical Simulator Suite is a flexible surgical training space which can comfortably accommodate up to 18 learners for seated clinical skills. The room includes a sink prep space for biological specimens. The space is also perfect for ultrasound training or interventional radiology using the Mentice simulator.

**Capacity:** 18

**AV:** Yes

**Video Conference:** No

**Learning Space Cameras:** No

**Room usage:** Surgical Skills.

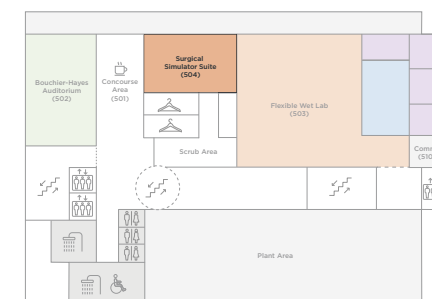

**5<sup>th</sup> FLOOR**

## Boucher-Hayes Auditorium (502)

The Boucher-Hayes Auditorium comfortably seats 50 participants for lectures or talks. The room is equipped with video-conferencing and AV facilities, and leads out to a large break-out space on the fifth floor. A catering station and reception desk can also be set up on this level.

**Capacity:** 50

**AV:** Yes

**Video Conference:** Yes

**Learning Space Cameras:** No

**Room usage:** Didactic Teaching.

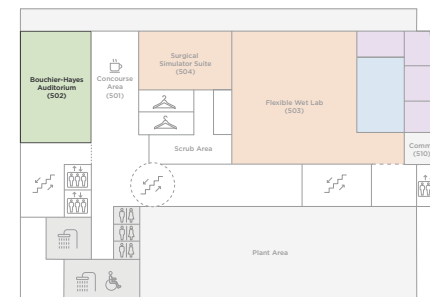



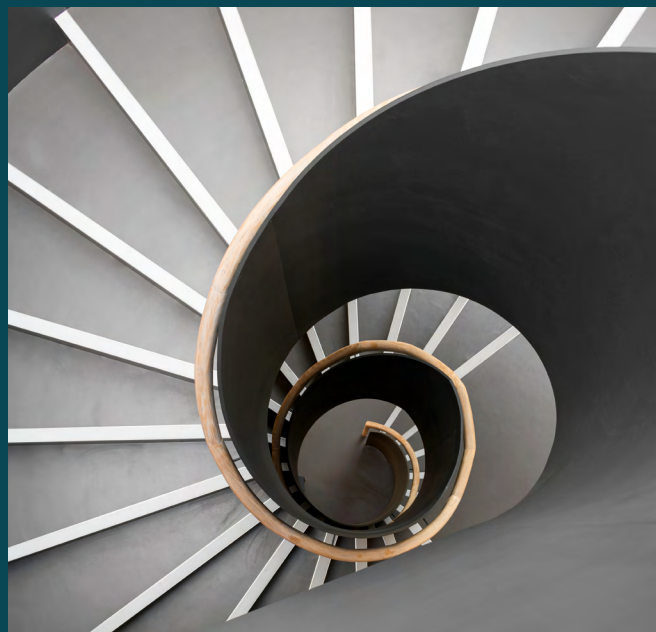

## Contact Us

**RCSI Centre for Simulation  
Education and Research**

**123 St Stephen's Green,  
Dublin 2, D02 YN77, Ireland.**

email: [simulation@rcsi.com](mailto:simulation@rcsi.com)

tel: +353 1 402 2100

[www.rcsi.com/simulation](http://www.rcsi.com/simulation)

